



Effortless Flow Measurement



AVFlow - How To Guide

Firstly, download the AVFlow App via the Apple Store for iOS or Google Play for Android.



The current AVFlow revisions are:

- iOS = 4.0.4
- Android = 2.2.4

The AVFlow app is FREE & designed to work with iOS 14.0 & above, & Android 6.0 & above.

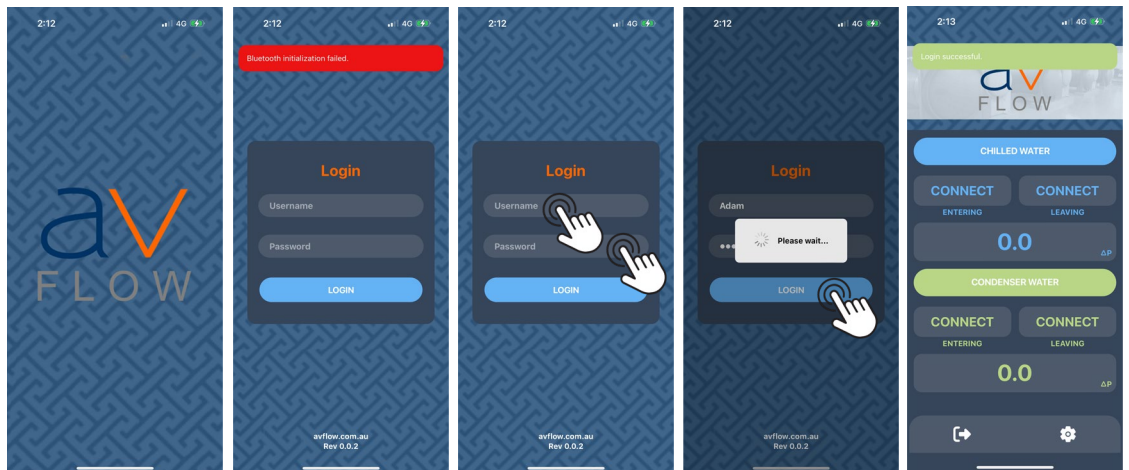

1. Open AVFlow by touching the newly installed app icon.
2. You will be presented with the AVFlow opening screen, & then a user login screen.
3. NOTE: You may see "Bluetooth Initialisation Failed" pop-up during first access at the login stage - this is ok.
4. Enter your "Username & Password" (provided by AVFlow Admin), then press "LOGIN".
5. Details will be verified (internet connection required), and a "Login Successful" pop-up will appear & then onto the AVFlow main screen.



Effortless Flow Measurement



1. AVFlow has been designed to be connected to four (4) AVFlow devices simultaneously.
2. AVFlow devices will be exclusive to only your Login credentials - a maximum of four (4).
3. You can use AVFlow devices for:
 - o Single static pressure measurement - 1 AVFlow
 - o Differential pressure measurement (single pressure vessel) - 2 AVFlows
 - o Differential pressure measurement (two (2) pressure vessels) - 4 AVFlows

The following steps will be used to connect any of your AVFlow devices to the AVFlow app:



1. Touch the word "CONNECT" at the first position.
2. This will open the AVFlow device page & automatically scan for 60 seconds, finding your allocated AVFlows. You will see a total of four (4) AVF-00000 devices. The numbers listed here will be matched to the number on the front of your AVFlow device.
3. Touch the chosen device number button, then a "Connecting to AVF-00000" pop-up will appear, & once complete, a "Connected to AVF-00000 Successfully" pop-up will appear.
4. Touching the same position will return you to the "Currently Connected To" screen, & you will see the active AVFlow device, Battery %, Zero Calibration & a Disconnect Function.
5. Repeat the same steps to connect all of your AVFlow devices to each remaining position.



Effortless Flow Measurement



It is always recommended to ensure that your AVFlow device is calibrated to Zero (0.00) before each use. This is a quick & simple process, completed as follows:

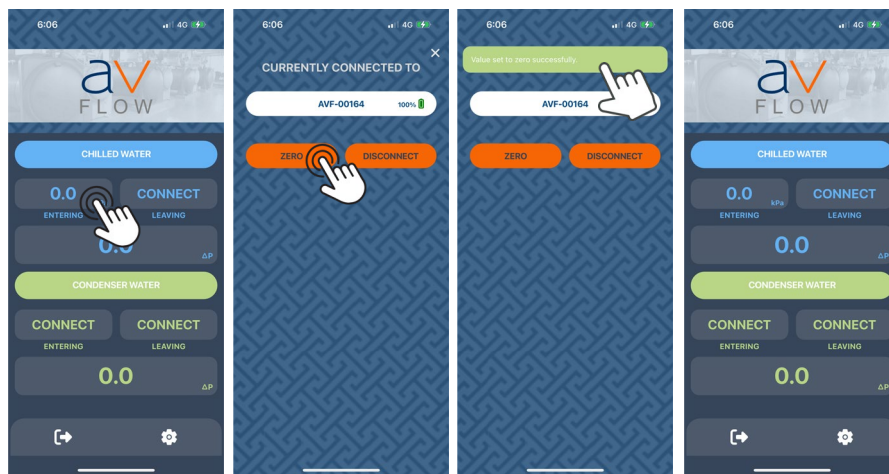

1. Touch any of the four (4) positions, & this will open up the "Currently Connected To" page.
2. Touch the "ZERO" button & this will initiate calibration.
3. Once completed, the "Value Set To Zero Successfully" pop-up will appear.
4. You can now return back to the main screen by touching the "X" in the top right-hand corner of the screen.
5. Due to the high sensitivity & accuracy of the sensor within the AVFlow device, you will see the occasional bounce between 0.0 / 0.69 / -0.69 - this is normal across all AVFlow devices.



Effortless Flow Measurement



You may want to change the current position of the AVFlow device to any of the remaining three (3) positions. This is a simple process & is performed as follows:



1. Touch any of the active AVFlow positions you would like to disconnect, & this will open up the "Currently Connected To" page.
2. Touch the "DISCONNECT" button & this will initiate disconnection.
3. Once completed, the "Device Disconnected" pop-up will appear & you will automatically be returned back to the main screen.
4. The position will display the old pressure reading in **RED** with a broken link icon .



Effortless Flow Measurement



How to Re-connect to an AVFlow Device:

Re-connection to an AVFlow device may be required should you walk out of range, or the Idle Time setting has reached its countdown limit. Reconnection is a simple process & is performed as follows:

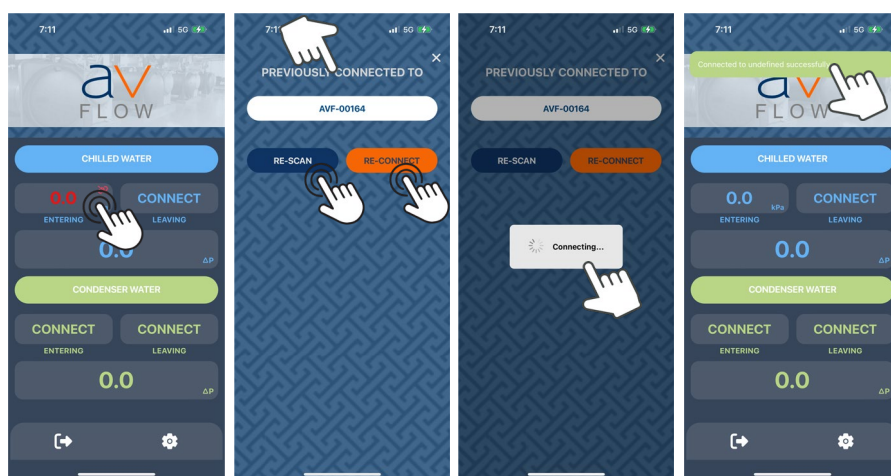

1. Touch any of the **RED** non-active AVFlow positions you would like to reconnect, & this will open up the "Previously Connected To" page.
2. This page will display the last connected AVFlow device to this position.
3. You can either touch "RE-SCAN" to connect to a new AVFlow device, or you can touch "RE-CONNECT" to connect to the last selected AVFlow device.
4. Touch the "RE-CONNECT" button & this will initiate re-connection, with a "Connecting" pop-up appearing.
5. Once completed, the "Device Connected" pop-up will appear & you will automatically be returned back to the main screen.
6. The position will display the new active pressure reading.



Effortless Flow Measurement



Settings | Options for AVFlow Use:

There are a variety of options on the Settings Tab. These are as follows:

- Theme:

Light

Dark (default)

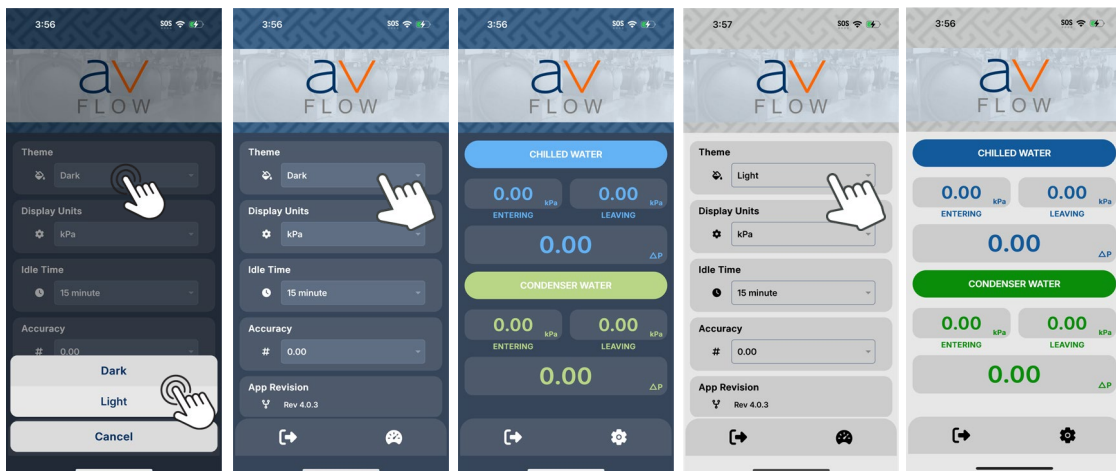

- Display Units:

kPa (kilopascals)

PSI (pounds per square inch)

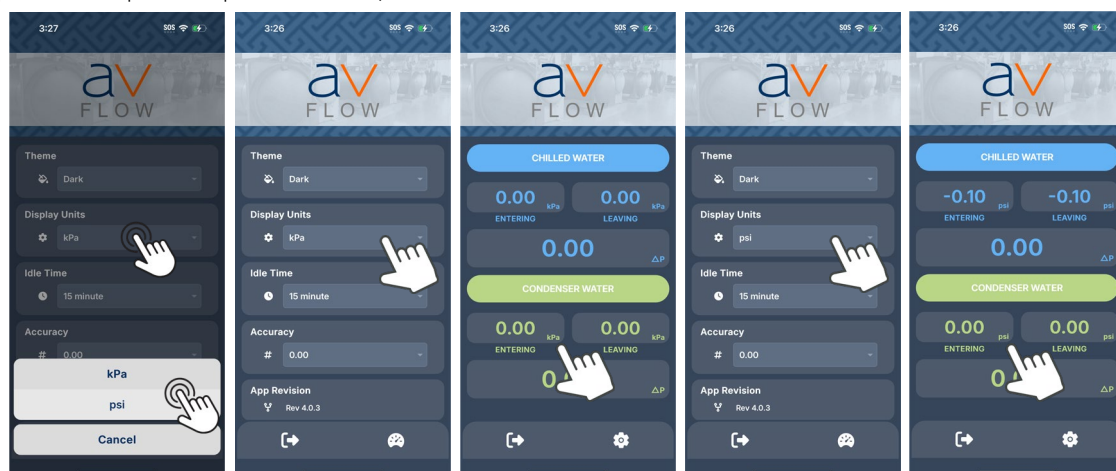



Effortless Flow Measurement



Settings | Options for AVFlow Use:

- **Idle Time:**

Set in 15-minute increments, this option automatically disconnects all AVFlow Transducers from your Bluetooth device after the selected duration, helping to extend battery life for both the transducers and your mobile device.

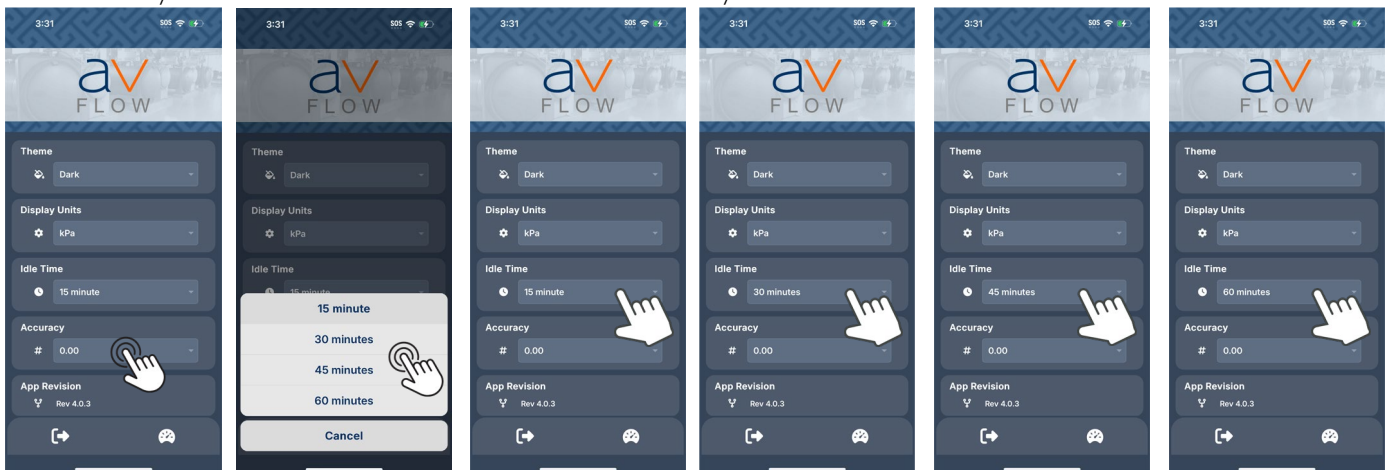

- **Accuracy:**

This setting adjusts the level of precision shown for the calculated ΔP (Delta P) value on the main tab.

0 - Whole number (no decimal places)

0.0 - One decimal place

0.00 - Two decimal places

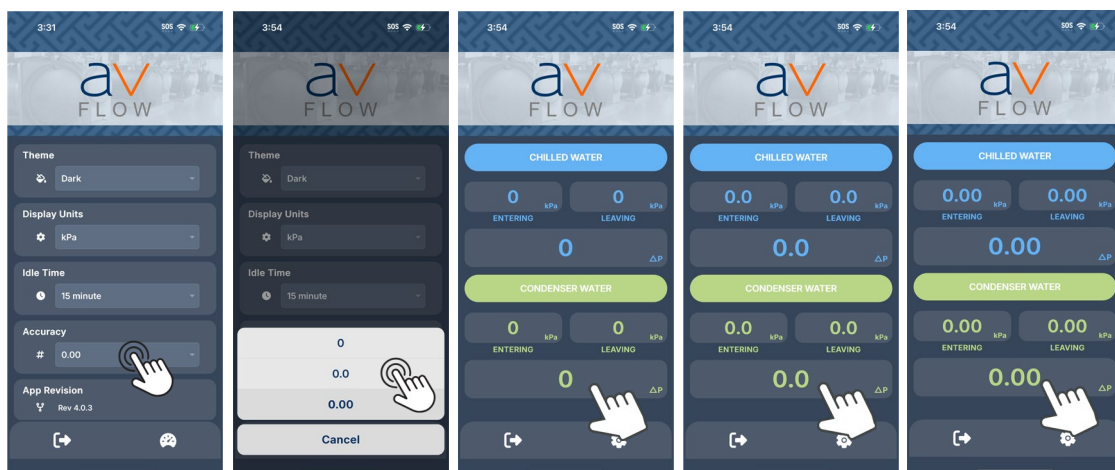



Effortless Flow Measurement



Settings | Options for AVFlow Use:

- App Revision:

The AVFlow app is designed to automatically update, ensuring you always have the latest features and improvements - with no need for manual checks or downloads. You can confirm the latest app version anytime by visiting our website.

